

FEEL THE EXPERIENCE

Aron Smart

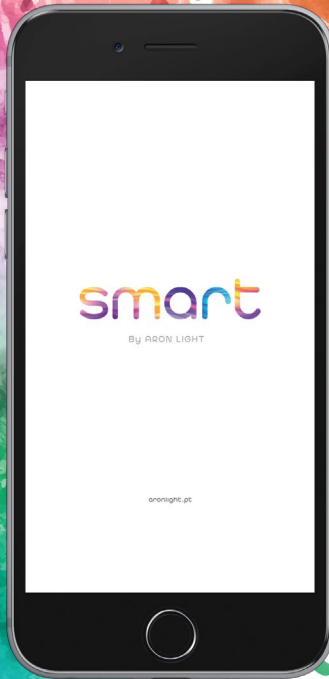

ARON SMART APP | TUTORIAL

Automate your World



ENGLISH

APP disponivel:



This tutorial seeks to clarify the users of the **Aron Smart** application. With this application the users can control their **Smart** lamps by turning them on/off, adjusting their brightness, setting their color, etc. This application also allows the control of **Smart** switches, sockets and cameras.

1 DOWNLOAD ARON SMART APP

The Aron Smart App can be downloaded from the **Play Store** (Android) and **App Store** (iOS). The application currently supports 3 languages:

- Portuguese
- English
- Spanish

To change the application language, change the system language in Phone Settings. When the system language is not supported, the default language of the application is English.

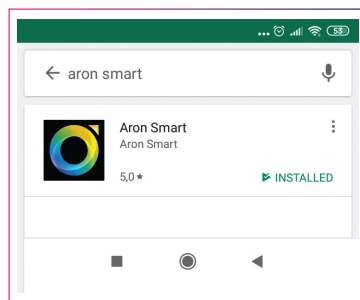

2 APP ACCESS

Log in to your account using your password. The first time you use the application, you must register with a new account, using your phone number or email address. You can configure your profile by going to '**Profile**' and clicking on the symbol '>' at the top right of the window.

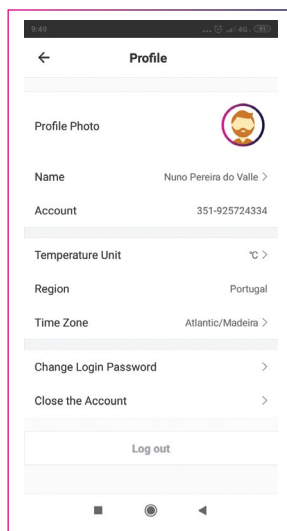
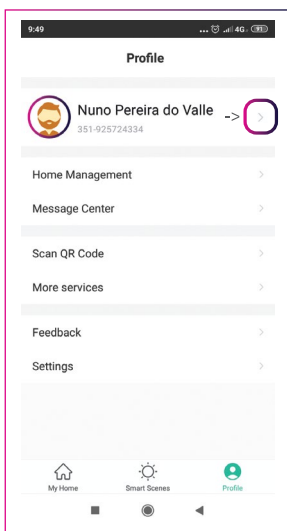

3 HOME SET-UP

A Home represents a place where the devices will be installed. A Home has one or several rooms.

3.1 CREATING A HOME

When there is no Home created yet, the 'Add Home' button appears on the screen. Press this button. It is also possible to add a Home by going to 'Profile' -> 'Home Management' -> 'Add Home'.

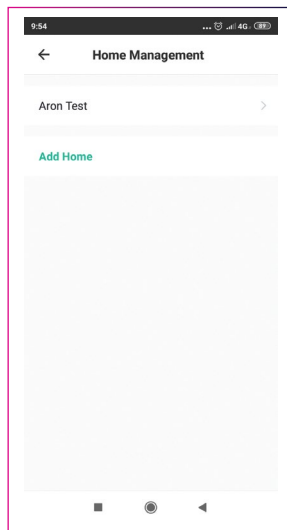
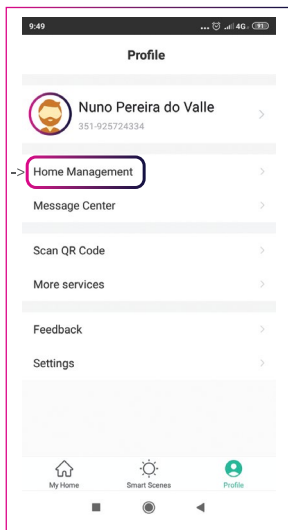

When you create a home you go to the 'Add Home' menu. In this menu you can define the 'Name' of the home, its 'Location' in the map and the list of rooms. You can remove rooms by deselecting them. You can add rooms by pressing 'Add another room'. When finished, press 'Done'.

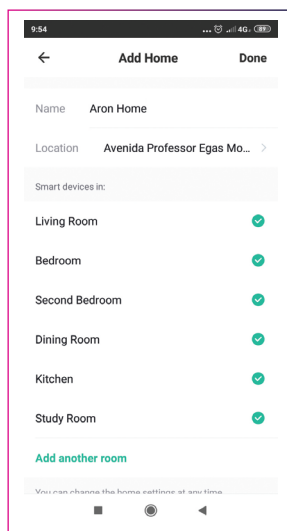

3.2 CHANGE HOME SETTINGS

You can always access and change the settings of a home by going to 'Profile' -> 'Home Management' -> <home name>. You can manage the rooms in 'Room Management'.

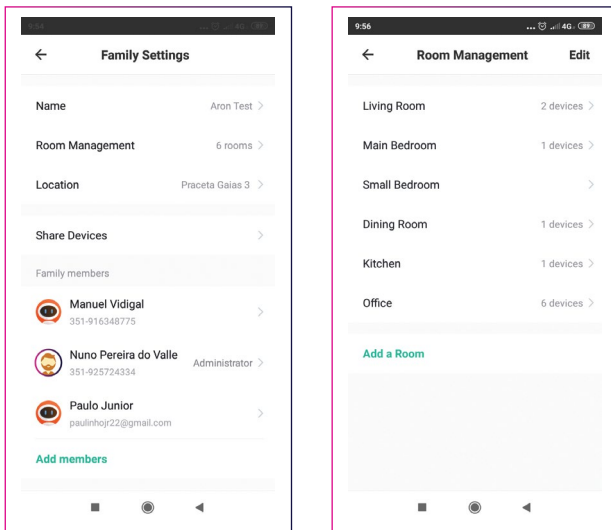

4 DEVICE SET-UP

To add one or multiple devices go to the 'My Home' screen and press 'Add Device'. Alternatively, you can click the '+' symbol in the upper right corner of the window.

4.1 LAMPS

Connect the lamp, which should flash quickly. If it does not blink, turn the lamp switch on and off 3 times until the lamp flashes rapidly.

4.2 SWITCH / SOCKET / CAMERA

Turn on the device and the LED should flash rapidly. If it does not blink, press and hold the button for 6 seconds, then the light will flash rapidly.

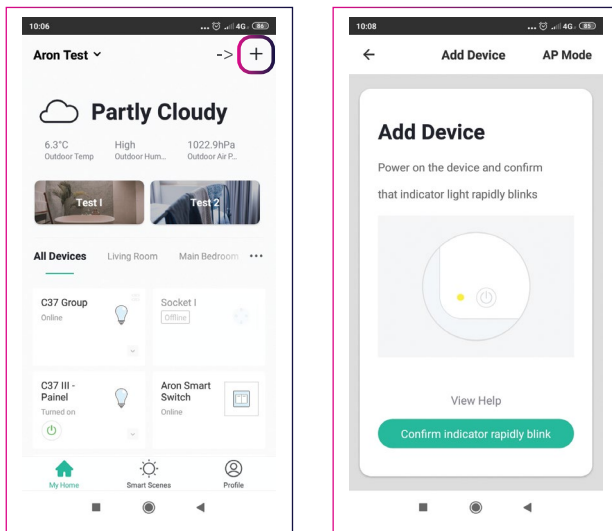

After confirming that the devices are blinking you must enter the Wi-Fi password. When you add a device you can give it a name and associate it with a room in the Home. To change the device settings you can click on the device icon in the 'My Home' window, then click on the top right of the window, accessing the 'Device Info' screen.

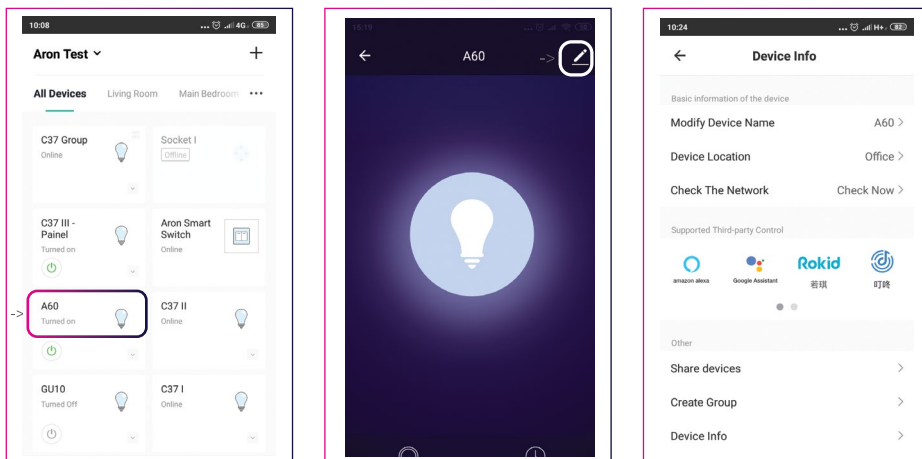

You can also change the room where the device is located in 'Profile' -> 'Home management' -> <home name> -> 'Room management' -> <room name>. When you add a device to a room, it is removed from the room where it was before.

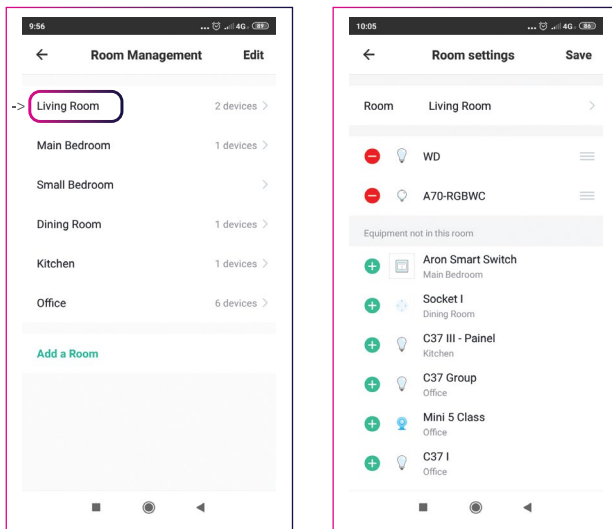

GROUPS: You can create groups of devices of the same type (lamps, switches or sockets). In the 'My Home' screen click on the device name. When you open the device configuration window click on the top right of the window, accessing the 'Device Info' menu. Then press 'Create Group' and select the devices that belong to the group. Each group is allocated to a room in the same way as a device.

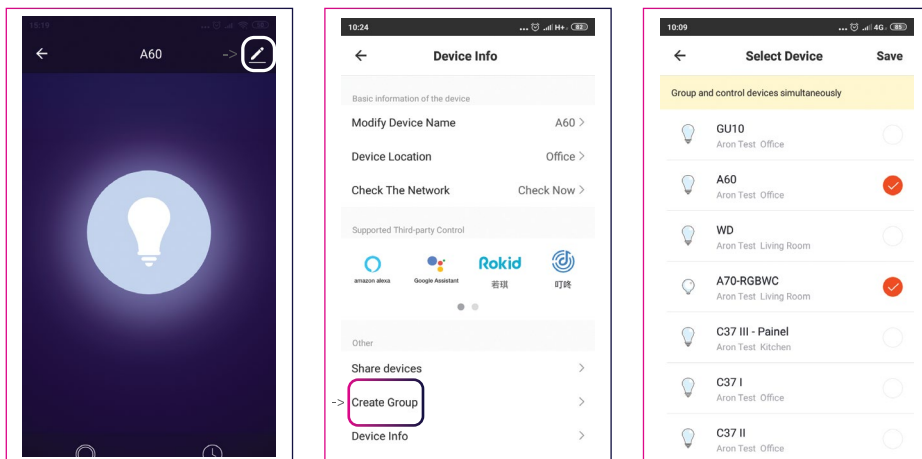

5 DEVICE CONTROL

The parameters of the devices / groups (switch on/off, brightness, color, etc.) can be changed manually or through **Scenes** or **Automations**, except for the cameras. Smart cameras have a particular control that is presented in Chapter 6.

5.1 MANUALLY

Click on the device/group in the 'My Home' screen and control the parameters that are available in the bottom range of the window. When controlling the parameters of a group, they will only have effect on a device in the group if it has this function.

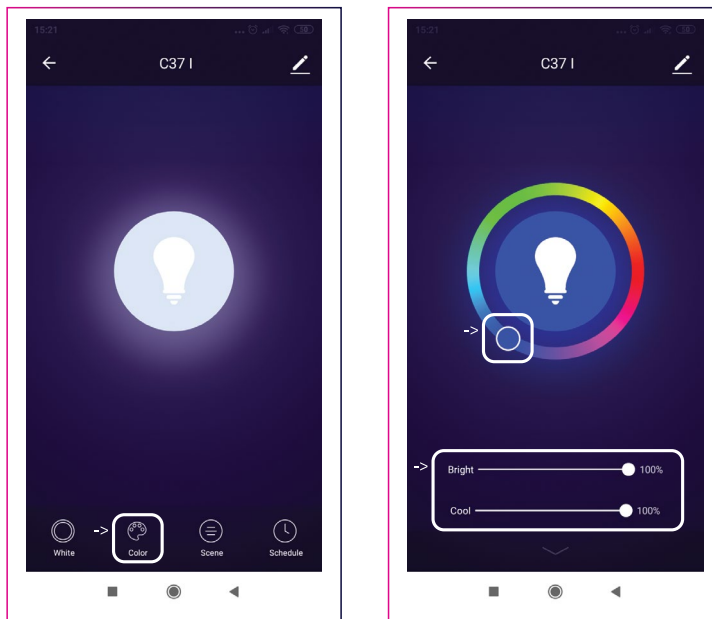

5.1.1 ADD SCHEDULE

When we select Timer/Schedule in the parameters of the device, we go to the 'Add Schedule' window. We can add a time to turn the device on/off by pressing the 'Add Schedule' button at the bottom of the page.

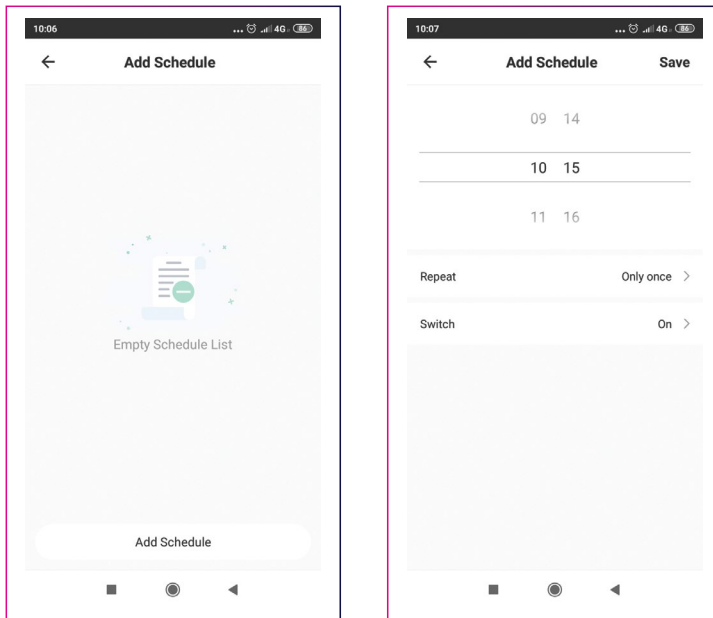

5.2 SCENE

A scene stores a set of device settings that are implemented when the scene is activated.

5.2.1 CREATE SCENE

Go to the 'Smart Scenes' window and press the '+' button at the top right of the window. Select 'Scene'. In the 'Smart Settings' menu you can name the scene, and you can add the device settings to be implemented by pressing '+' next to 'Perform the following actions'. Whenever you add an action you must choose which device, which parameter to control, and what is the value (e.g. GUI0 -> Bright -> 255).

If 'Show on the dashboard' is enabled, the scene will appear on the 'My Home' screen. When finished, press 'Save' in the upper corner of the screen.

NOTE: controlling the RGB colour of a lamp through scenes is not supported. The colour temperature range is from 1 (warm) to 255 (cold).

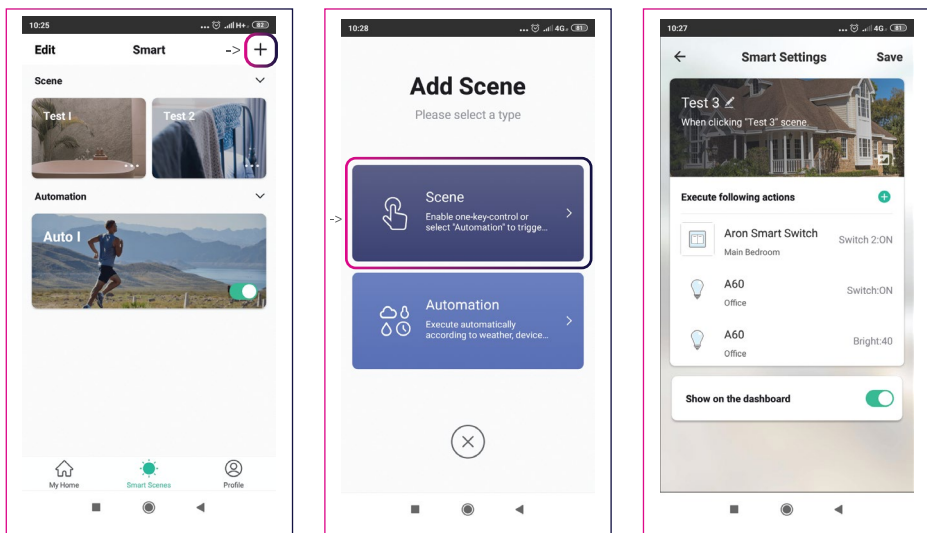

5.2.2 ACTIVATE SCENE

Go to the 'Smart Scenes' window and click on the scene to implement.

5.3 AUTOMATION

An automation is similar to a scene because it implements a set of device settings.

The difference is that an automation is automatically triggered when certain conditions are met.

5.3.1 CREATE AUTOMATION

Go to the '**Smart Scenes**' window and press the '+' button at the top right of the window. Select '**Automation**'. In the '**Smart Settings**' screen you can name the automation, and you can define the settings to be satisfied by pressing the '+' button next to '**When any condition is satisfied**' (e.g. **Temperature** -> **10°C**).

Alternatively, you can choose to trigger the automation '**When all conditions are satisfied**'.

You can configure the device settings to be implemented by pressing '+' next to '**Perform the following actions**'.

To define in which time period the automation can be triggered go to '**Time segment validation**'.

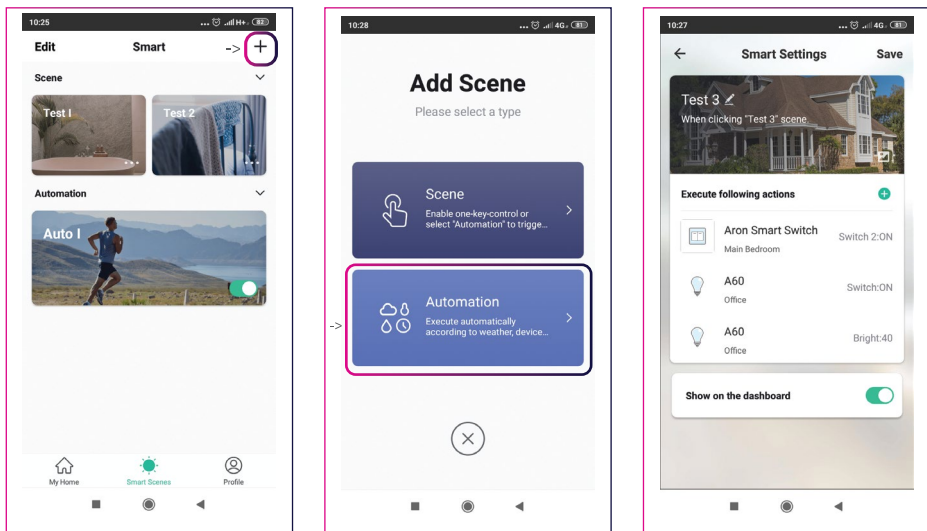

6 CAMERA CONTROL

To access the camera control you must click on the camera icon in the 'My Home' screen. If the camera is turned on, the video image will be broadcasted in the upper half of the screen. On the video screen we have the following parameters or functionalities:

6.1 CURRENT DATE AND TIME

In the upper left corner. If it does not appear, you should click on the upper right corner '...' to access the camera settings, and activate on 'Basic Feature Settings' -> 'Time Watermark'.

6.2 SIGNAL %

In the upper right corner. Indicates how strong the Wi-Fi signal is in the connection to the camera.

6.3 LOUDSPEAKER

In the lower left corner of the video screen. Indicates whether the sound received from the camera microphone is played on your phone. Press to turn on/off. If the audio mode is one-way in the 'Basic Feature Settings' the speaker turns off automatically when the Speak feature is activated.

6.4 SD/HD

Next to the loudspeaker. Indicates whether the image quality is low (SD) or high (HD).

6.5 FULL SCREEN

Bottom corner of the video screen. Enables the full screen.

6.6 TEMPERATURE SENSOR

Icon of a thermometer in the center of the screen. If the sensor is not connected to the camera, the value will be unreal.

6.7 HUMIDITY SENSOR

A drop icon in the center of the screen. If the sensor is not connected to the camera the value will be unreal.

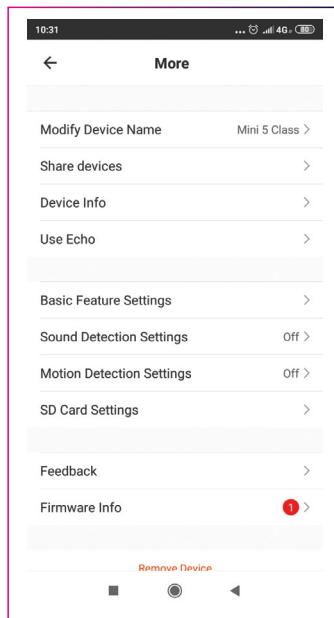
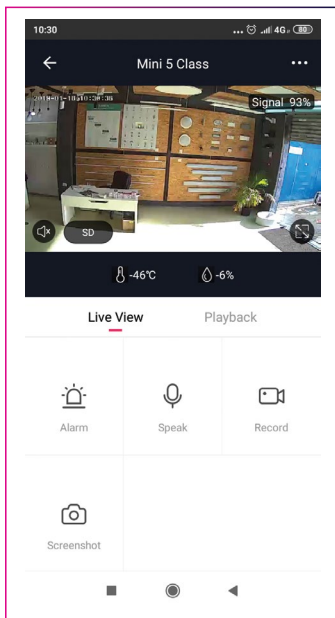

6.8 LIVE VIEW

When this mode is on you are watching the live video stream. The following features are available in this mode:

6.8.1 ALARM

Access the 'Motion Detection Settings' menu, where you can activate the alarm and the sensitivity of the motion sensor.

6.8.2 SPEAK

When active, the sound captured by the phone's microphone will be played back on the camera speaker. If the audio mode is one-way in the 'Basic Feature Settings' the loudspeaker turns off automatically when the Speak feature is active.

6.8.3 RECORD

Records a certain duration of the video stream.

6.8.4 SCREENSHOT

Saves a screenshot of the video stream.

6.9 PLAYBACK

In order to access this mode you must have a micro SD card inserted in the back of the camera. With a micro SD card, the camera stores the video stream from the most recent hours / days (e.g. last 30 days). The capacity depends on the available space on the SD card.

This mode allows you to play back the video stream from a past hour or date in the upper half of the screen. In the center of the screen there is a bar with the time of day. By sliding this bar to the left, we can access the recorded video at a certain time in the past.

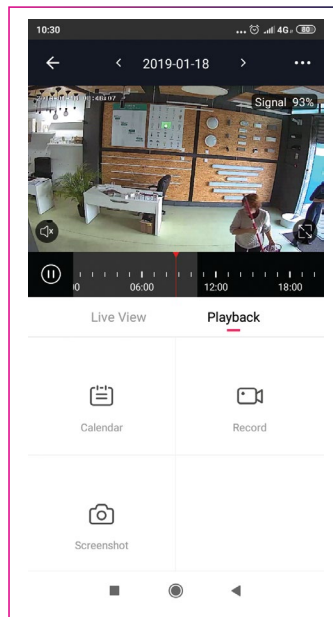

6.9.1 CALENDAR

When you click on the Calendar, it is possible to access the recordings of past days.

6.9.2 RECORD

When you press Record, the phone starts to record the video stream to its internal storage.

6.9.3 SCREENSHOT

When you press it, the phone saves a screenshot for internal storage.

7 CAMERA, SENSORS AND NOTIFICATIONS

One of the functionalities of the camera is the ability to detect sound and movement. If the sensors are switched on, the user will be notified when any presence triggers the sensors. You can configure each sensor by pressing the camera icon in 'My Home', then press '...' in the upper right corner to access the 'More' menu. Then:

7.1 MOTION SENSOR

Press 'Motion Detection Settings'. Then activate the motion detection alarm and select the sensitivity.

Whenever the motion detection alarm is triggered the user receives a screenshot of the video stream in 'Profile' -> 'Message Center'.

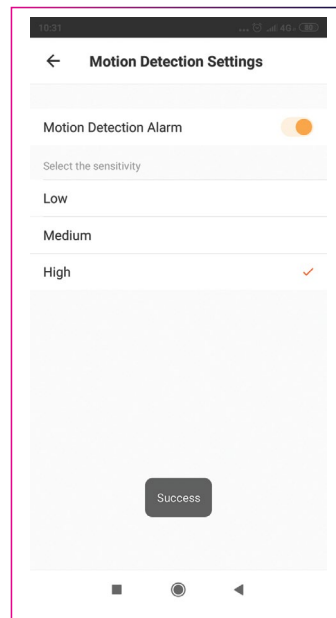
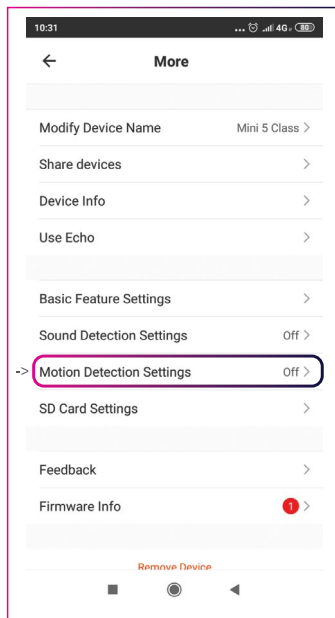

7.2 SOUND SENSOR

Press '[Sound Detection Settings](#)'. Then activate the sound detection alarm and select the sensitivity. Whenever the sound detection alarm is activated the user receives a text message in '[Profile](#)' -> '[Message Center](#)'.

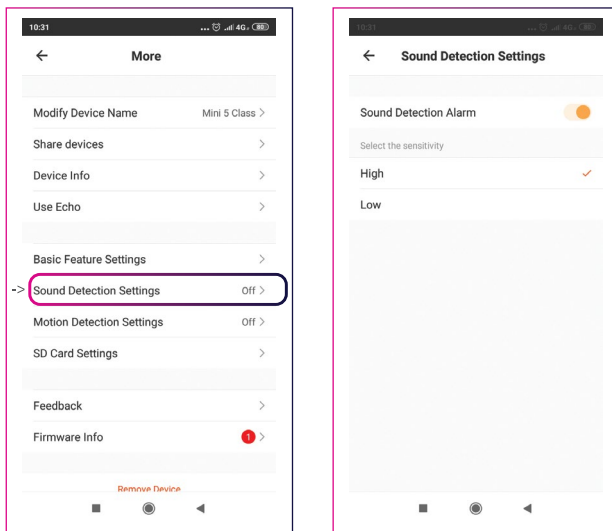

8 SHARE CONTROL

You can share device control with other users as follows:

8.1 SHARE HOME

Shares control of all devices in the home with other members. Members who share control of a home are a Family. To add a family member you must go to '[Profile](#)' -> '[Home management](#)' -> '[home name](#)' -> '[Add members](#)'. If you do not select '[Set as administrator](#)', the member can not add / remove devices and scenes.

8.2 SHARE A DEVICE/GROUP

In the '[My Home](#)' screen click on the device/group and go to the '[Device Info](#)' / '[Group Details](#)' menu by clicking on the top right of the window. Then tap '[Share devices](#)' or '[Share group](#)', and then press '[Add](#)'. Enter the account info of the member you want to share with.

9 INTEGRATION WITH OTHER SERVICES

You can control Smart devices through services like Amazon Alexa or Google Home. To see how to configure the integration go to '[Profile](#)' -> '[More services](#)' -> '[service name](#)'.

FEEL THE EXPERIENCE



Aron Smart

Praceta das Gaias, 1 e 2
2610-110 Alfragide
+351 215 846 905

geral@aronlight.pt
www.aronlight.pt

Automate your World



APP disponível:

